

#2017158502, #2017158503, #2017158504, #2017158505

IRISH SETTER CLUB OF GREATER TULSA, INC.

All-Breed Obedience & Rally Trials
Classes limited to 8 hours of judging
OPEN TO ALL AKC RECOGNIZED BREEDS



THIS SHOW WILL BE INDOORS AND UNBENCHED
Air Conditioned, Fully Matted Rings

Saturday, June 3, 2017 - Sunday, June 4, 2017

All Breed Rally

All Breed Obedience

Companion Dog School of Tulsa

4411 South 91st East Ave. - Tulsa, OK 74145

SHOW HOURS: 8:00 a.m. to 6:00 p.m.

See Judging Program for Trial Opening

ONLINE ENTRY (Recommended): enterdogevent.com

CLUB WEBSITE: iscgt.org

ENTRIES CLOSE AT 6:00 p.m. on Wednesday, May 17, 2017

MAIL ALL ENTRIES WITH CHECKS PAYABLE TO:

ISCGT

P.O. Box 4567 – Tulsa, OK 74159 – (918) 906-3776

EMAIL: event@iscgt.org

Permission has been granted by the American Kennel Club for the holding of this event under American Kennel Club rules and regulations.

James P. Crowley, Secretary



OFFICERS

President	Susan Moren
Vice President	Jeanine Harris
Treasurer	Hugh Holly III
Secretary	Anna Vaughn

8316 East 14th St. - Tulsa, OK 74112 (918) 906-3776 - anna@cme-usa.com

BOARD OF DIRECTORS

Sarah Schroeder	Jana Davis	Holly Kruse
-----------------	------------	-------------

SHOW COMMITTEE

Obedience Chairman	Susan Moren
Obedience Secretary	Anna Vaughn
Chief Ring Steward	Jana Davis
Trophies	Jeanine Harris
Grounds	Hugh Holly III

Trial Photographer	Sonja Jo Hahn
--------------------	---------------

PO Box 602 - Bixby, OK 74008 shutterbugrebel@aol.com

JUDGES

Saturday, June 3, 2017 Event# 2017158502 AKC Rally®, Novice, Advanced, Excellent	Sarah Schroeder 5741 E Meadowmere St, Springfield, MO 65809
Saturday, June 3, 2017 Event# 2017158503 Obedience (Open & Utility), Preferred Open	Mrs. Susan Oviatt-Harris 5372 Lenox Ct, Castle Rock, CO 80104
Obedience (Beg. Novice, Novice, Preferred Novice)	Sarah Schroeder 5741 E Meadowmere St, Springfield, MO 65809
Sunday, June 4, 2017 Event# 2017158504 AKC Rally®, Novice, Advanced, Excellent	Sarah Schroeder 5741 E Meadowmere St, Springfield, MO 65809
Sunday, June 4, 2017 Event# 2017158505 Obedience (Open & Utility), Preferred Open	Mrs. Susan Oviatt-Harris 5372 Lenox Ct, Castle Rock, CO 80104
Obedience (Beg. Novice, Novice, Preferred Novice)	Sarah Schroeder 5741 E Meadowmere St, Springfield, MO 65809

ENTRY FEES

(All Fees include AKC Recording Fee)

Entry Fee (except as noted below)	\$30.00
Second Entry (same dog, same trial)	\$25.00

Obedience & Rally are separate trials

ENTRY DEADLINE: Wednesday, May 17, 2016 – 6:00 p.m.

SHOW SECRETARY: Anna Vaughn PO Box 4567 Tulsa, OK 74159 event@iscgt.org

ONLINE ENTRY: enterdogevent.com

SHOW VETERINARIAN

Animal Emergency Center, Inc.
4055 S. 102nd East Ave. – Tulsa, OK 74146
(918) 665-0508
Open 24/7

Located less than 1.5 miles from the show site.

Directions:
Turn right (North) out of the show site parking.
Turn right onto E BA Frontage Rd.
Turn left onto S. Mingo Rd.
Take the 2nd right onto E 41st St.
Take the 2nd left onto S 102nd St.
Located directly behind Popeye's Chicken

RALLY
Rally Classes

Rally Novice A	Rally Advanced A	Rally Excellent A
Rally Novice B	Rally Advanced B	Rally Excellent B

RALLY RIBBONS

First Prize	Blue Ribbon
Second Prize	Red Ribbon
Third Prize	Yellow Ribbon
Fourth Prize	White Ribbon
Highest Combined Score in Advanced & Excellent	Blue & Green Rosette

OBEDIENCE
Obedience Classes

Beginner Novice A	Open A	Utility A
Beginner Novice B	Open B	Utility B
Novice A	Preferred Open	
Novice B		
Graduate Novice		
Preferred Novice		

OBEDIENCE RIBBONS

First Prize	Blue Ribbon
Second Prize	Red Ribbon
Third Prize	Yellow Ribbon
Fourth Prize	White Ribbon
Highest Scoring Dog in the Regular Classes	Blue & Gold Rosette
Highest Combined Score in Open B & Utility B	Blue & Green Rosette
Highest Scoring Dog in the Preferred Classes	Blue & Gold Rosette
Qualifying Score in the Regular Classes	Dark Green Ribbon

TROPHIES

A LIST OF BREED AND OBEDIENCE PRIZES AND TROPHIES OFFERED CAN BE OBTAINED BY WRITING TO THE
CLUB SECRETARY: Anna Vaughn - 8316 East 14th St., Tulsa, OK 74112

Trophies will be listed on the Irish Setter Club of Greater Tulsa website:

ISCGT.ORG

FREE LUNCH PROVIDED!!!

ROUTE TO THE SHOW

From Interstate 44:

Exit #231 S. Memorial Ave.
Drive South to 46th Street (light)
Turn Left Drive to South 91st East Ave.
Turn Left The show grounds are on the Right.
THERE WILL BE SIGNS POSTED

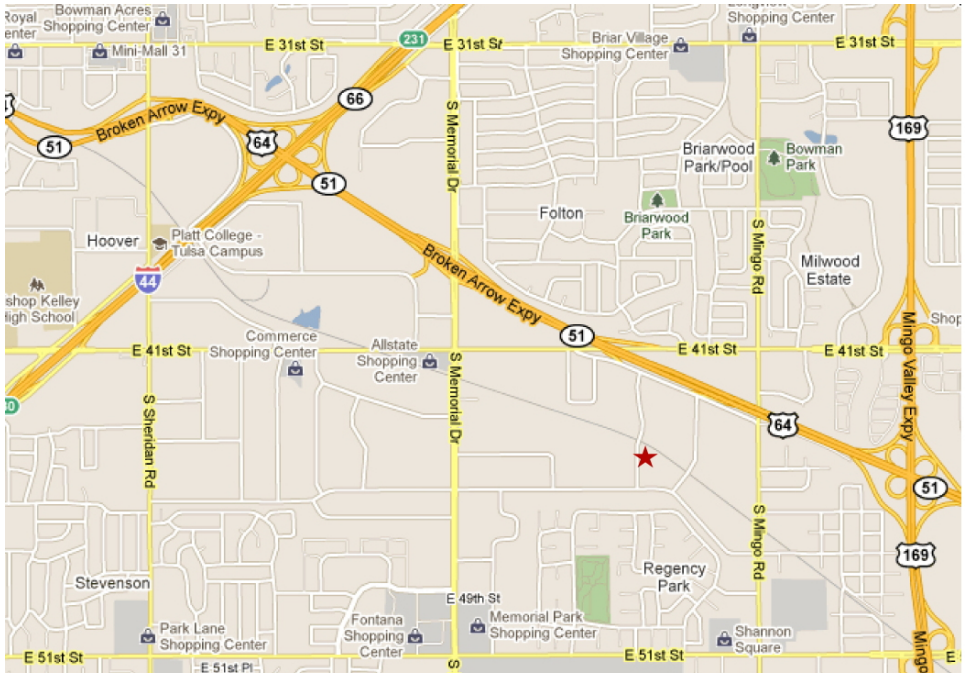

ACCOMODATIONS

LaQuinta Tulsa East
10829 East 41st St.
Tulsa, OK 74146

(918) 665-0220
(800) 753-3757
Pet Friendly

Expo Square RV Park
3900 East 15th St.
Tulsa, OK 74114

(918) 744-1113
exposquare.com

CONVENIENCES

TGI Fridays
On the Border
Promenade Mall

5359 East 41st St. Tulsa, OK 74135
5340 East 41st St. Tulsa, OK 74135
4107 South Yale Ave. Tulsa, OK 74135

NOTICE TO EXHIBITORS

Entry Fees include \$3.50 AKC Event Fee and \$.50 AKC recording fee.

Dogs will be shown indoors in air conditioned building - crating and grooming areas are available.

THERE WILL BE NO ALCOHOL ALLOWED ON THE PREMISIS.

Dogs need be present only for judging. ALL DOGS MUST BE OUT OF THE BUILDING 1 HOUR AFTER JUDGING ENDS. NO EXCEPTIONS!

Entry fees will not be refunded in the event a dog is absent, disqualified, excused by the judge or barred from competition by action of the Trial Committee.

If because of riots, civil disturbances or other acts beyond the control of the match-giving club it is impossible to open or complete the match, no refund of entry fees will be made.

Dogs must be ready for judging. The owner or handler of each dog is solely responsible for having such dog ready at ringside when his class is ready to be judged.

Space will not be provided at this trial for un-entered dogs.

The trial-giving club and its membership assume no responsibility for any loss, damage or injury sustained by exhibitors, handlers or any of their dogs or property, and further assume no responsibility for injury to children.

Officers and members of the Irish Setter of Greater Tulsa will exhibit dogs at this trial.

Exhibitors and handlers will be held responsible for clean conditions in and around their crating and grooming area.

Parents will be held responsible for the conduct of their children at this trial.

No entry shall be made, and no entry shall be accepted, which specifies any condition as to its acceptance. Entries will not be accepted without fees or signatures.

Changes, additions or corrections to entry forms must be received in writing or by telegram prior to close of entries. Those received by telephone are not acceptable.



WE'RE BEGGIN' YOU!

Our friends at the Companion Dog School of Tulsa have graciously rented their wonderful facility to us so please help us keep their building and grounds clean!

Poop bags are available at the door.

OFFICIAL AMERICAN KENNEL CLUB ENTRY FORM

IRISH SETTER CLUB OF GREATER TULSA, INC.

Entries Close Wednesday, May 17, 2017.

- | | |
|------------------------------------|-------------------------------------|
| <input type="checkbox"/> Rally | Saturday, June 3, 2017 # 2017158502 |
| <input type="checkbox"/> Obedience | Saturday, June 3, 2017 # 2017158503 |
| <input type="checkbox"/> Rally | Sunday, June 4, 2017 # 2017158504 |
| <input type="checkbox"/> Obedience | Sunday, June 4, 2017 # 2017158505 |

I ENCLOSE \$ _____ for entry fees.

IMPORTANT: Read Carefully the Instructions on the Reverse Side Before Filling Out. Numbers in parenthesis indicate sections of the instructions relevant to the information needed. **PLEASE PRINT**

BREED		VARIETY (1)		SEX	
DOG SHOW CLASS (2)(3)		CLASS DIVISION (3) Weight, Color, etc.			
ADDITIONAL CLASSES	OBEDIENCE CLASS (Jump Height)	RALLY CLASS (Jump Height)	JR SHOWMANSHIP CLAA		
NAME OF (See Back) JR HANDLER (if any)			JR HANLDER NUMBER		
FULL NAME OF DOG					
<input type="checkbox"/> AKC REG NO. <input type="checkbox"/> AKC LITTER NO. <input type="checkbox"/> ILP NO. <input type="checkbox"/> FOREIGN REG NO.& COUNTRY		Enter Number Here	DATE OF BIRTH		
		PLACE OF BIRTH <input type="checkbox"/> USA <input type="checkbox"/> CANADA <input type="checkbox"/> FOREIGN			
BREEDER					
SIRE					
DAM					

ACTUAL OWNERS (S) _____
(Please Print)

OWNERS ADDRESS _____

CITY _____ STATE _____ ZIP _____

NAME OF OWNERS AGENT
 (if any) AT THE SHOW _____

I CERTIFY that I am the actual owner of the dog, or that I am the duly authorized agent of the actual owner whose name I have entered above. In consideration of the acceptance of this entry. I (we) agree to abide by the rules and regulations of The American Kennel Club in effect at the time of this show, obedience trial and/or agility trial, and by any additional rules and regulations appearing in the premium list for this show, obedience trial and/or agility trial, and further agree to be bound by the "Agreement" printed on the reverse side of this entry form. I (we) certify and represent that the dog entered is not a hazard to persons or other dogs. This entry is submitted for acceptance on the foregoing representation and agreement.

SIGNATURE of owner or his agent duly authorized to make this entry _____

TELEPHONE NUMBER (Include Area Code) _____

E-MAIL ADDRESS _____

OFFICIAL AMERICAN KENNEL CLUB ENTRY FORM

IRISH SETTER CLUB OF GREATER TULSA, INC.

Entries Close Wednesday, May 17, 2017.

- Rally
 Obedience
 Rally
 Obedience

Saturday, June 3, 2017 # 2017158502
Saturday, June 3, 2017 # 2017158503
Sunday, June 4, 2017 # 2017158504
Sunday, June 4, 2017 # 2017158505

I ENCLOSE \$ _____ for entry fees.

IMPORTANT: Read Carefully the Instructions on the Reverse Side Before Filling Out. Numbers in parenthesis indicate sections of the instructions relevant to the information needed. **PLEASE PRINT**

BREED		VARIETY (1)		SEX	
DOG SHOW CLASS (2)(3)		CLASS DIVISION (3) Weight, Color, etc.			
ADDITIONAL CLASSES	OBEDIENCE CLASS (Jump Height)	RALLY CLASS (Jump Height)		JR SHOWMANSHIP CLAA	
NAME OF (See Back) JR HANDLER (if any)				JR HANLDER NUMBER	
FULL NAME OF DOG					
<input type="checkbox"/> AKC REG NO. <input type="checkbox"/> AKC LITTER NO. <input type="checkbox"/> ILP NO. <input type="checkbox"/> FOREIGN REG NO.& COUNTRY			Enter Number Here	DATE OF BIRTH	
				PLACE OF BIRTH	<input type="checkbox"/> USA <input type="checkbox"/> CANADA <input type="checkbox"/> FOREIGN
BREEDER					
SIRE					
DAM					

ACTUAL OWNERS (S) _____

(Please Print)

OWNERS ADDRESS _____

CITY _____

STATE _____

ZIP _____

NAME OF OWNERS AGENT (if any) AT THE SHOW _____

I CERTIFY that I am the actual owner of the dog, or that I am the duly authorized agent of the actual owner whose name I have entered above. In consideration of the acceptance of this entry. I (we) agree to abide by the rules and regulations of The American Kennel Club in effect at the time of this show, obedience trial and/or agility trial, and by any additional rules and regulations appearing in the premium list for this show, obedience trial and/or agility trial, and further agree to be bound by the "Agreement" printed on the reverse side of this entry form. I (we) certify and represent that the dog entered is not a hazard to persons or other dogs. This entry is submitted for acceptance on the foregoing representation and agreement.

SIGNATURE of owner or his agent duly authorized to make this entry _____

TELEPHONE NUMBER (Include Area Code) _____

E-MAIL ADDRESS _____

AGREEMENT

I (we) acknowledge that the "Rules Applying to Dog Shows/Registration and Discipline" and, if this entry is for an obedience trial and/or agility trial, the "Obedience Regulations", and/or the "Agility Trial Regulations", have been made available to me (us), and that I am (we are) familiar with their contents. I (we) waive any and all claims, causes of action, I (we) might otherwise have against the AKC and any AKC approved judge, judging at this show, under the "AKC Rules, Regulations and Guidelines". I (we) agree that the club holding this show, obedience trial and/or agility trial has the right to refuse this entry for cause which the club shall deem to be sufficient. In consideration of the acceptance of this entry and of the holding of the show, obedience trial or agility trial and of the opportunity to have the dog judged and to win prize money, ribbons, or trophies, I (we) agree to hold this club, its members, directors, governors, officers, agents, superintendents or show secretary and the owner or lessor of the premises and any employees of the aforementioned parties, harmless from any claim for loss or injury which may be alleged to have been caused directly or indirectly to any person or thing by the act of this dog while in or upon the show or obedience trial premises or agility trial premises or grounds or near any entrance thereto, and I (we) personally assume all responsibility and liability for any such claim; and I (we) further agree to hold the aforementioned parties harmless from any claim for loss of this dog by disappearance, theft, death or otherwise, and from any claim for damage or injury to the dog, whether such loss, disappearance, theft, damage or injury, be caused or alleged to be caused by the negligence of the club or any of the parties aforementioned, or by the negligence of any other person, or any other cause or causes. I (we) hereby assume the sole responsibility for and agree to indemnify and save the aforementioned parties harmless from any and all loss and expense (including legal fees) by reason of the liability imposed by law upon any of the aforementioned parties for damage because of bodily injuries, including death at any time resulting therefrom, sustained by any person or persons, including myself (ourselves) or on account of damage to property, arising out of or in consequence of my (our) participation in this show or obedience trial or agility trial, howsoever such injuries, death or damage to property may be caused, and whether or not the same may have been caused or may have been alleged to have been caused by negligence of the aforementioned parties or any of their employees or agents, or any other persons.

INSTRUCTIONS

- (Variety) if you are entering a dog of a breed in which there are varieties for show purposes, please designate the particular variety you are entering i.e., Cocker Spaniel (solid color black, ASCOB, parti-color), Beagles (not exceeding 13 in., over 13 in. but not exceeding 15 in.), Dachshunds (longhaired, smooth, wirehaired), Bull Terriers (colored, white), Manchester Terriers (standard, toy), Chihuahuas (smooth coat, long coat), English Toy Spaniels (King Charles and Ruby, Blenheim and Prince Charles), Poodles (toy, miniature, standard), Collies (rough, smooth).
- The following categories or dogs may be entered and shown in Best of Breed competition; Dogs that are Champions of Record and dogs which according to their owners records, have completed the requirements for a championship, but whose championships are unconfirmed. The showing of unconfirmed Champions in Best of Breed competition is limited to a period of 90 days from the date of the show where the dog completed the requirements for a championship.
- (Dog Show Class) Consult the classification in the show's premium list. If the dog show class in which you are entering your dog is divided, then, in addition to designating the class, specify the particular division of the class in which you are entering your dog, i.e. age division, color division, weight division.
- A dog must be entered in the name of the person who actually owned it at the time entries for a show closed. If a registered dog has been acquired by a new owner, it must be entered in the name of its new owner in any show for which entries closed after the date of acquirement, regardless of whether the new owner has received the registration certificate indicating that the dog is recorded in his name. State on entry form whether transfer application has been mailed to A.K.C. (For complete rule refer to Chapter 11, Section 3).

If this entry is for Junior Showmanship, please give the following:

AKC Junior Handler # _____ **Junior's Date of Birth** _____

The above number **MUST** be included. Should you not have your Junior Handler number, this may be obtained from the American Kennel Club. (Phone) 919-854-0136.

ADDRESS _____

CITY _____ **STATE** _____ **ZIP** _____

If Junior Handler is not the owner of the dog identified on the face of this form, what is the relationship of the Junior to the owner?